

Tremendous Value in Sierra Madre



145 Grove Steet, Sierra Madre

Offered at: \$575,000

Home: 2,072 sqft (assessor) Lot: 4,731 (assessor)

Two-Story turn of the century farm house with huge potential. This 2,072 sqft home features 5BR/2BA, on a 4,731 sqft lot. Built in the late 1800's this home retains many of its original features including: stone fireplace, hardwood flooring and architectural accents. Rare opportunity to restore this gem back to its original splendor.



155 Grove Steet, Sierra Madre

Offered at: \$375,000

Home: 692 sqft (assessor) Lot: 5,535 (assessor)

Adjacent to 145 Grove Street, this cottage features 2BR/1BA on a flat, grassy 5,535 sqft lot. Historically used as an income property for 145 Grove Street, this home offers tremendous potential and value.

General inspection reports available to all potential buyers at: www.brentchang.com/grove

Both properties sold in "as is" condition.

626.685.5271 | Linda Chang
Previews Estate Director
lindachang@coldwellbanker.com

626.685.5236 | Brent C Chang
brent@brentchang.com



RESIDENTIAL BROKERAGE

www.lindachang.com

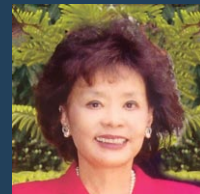

**155 N. GROVE STREET,
SIERRA MADRE**

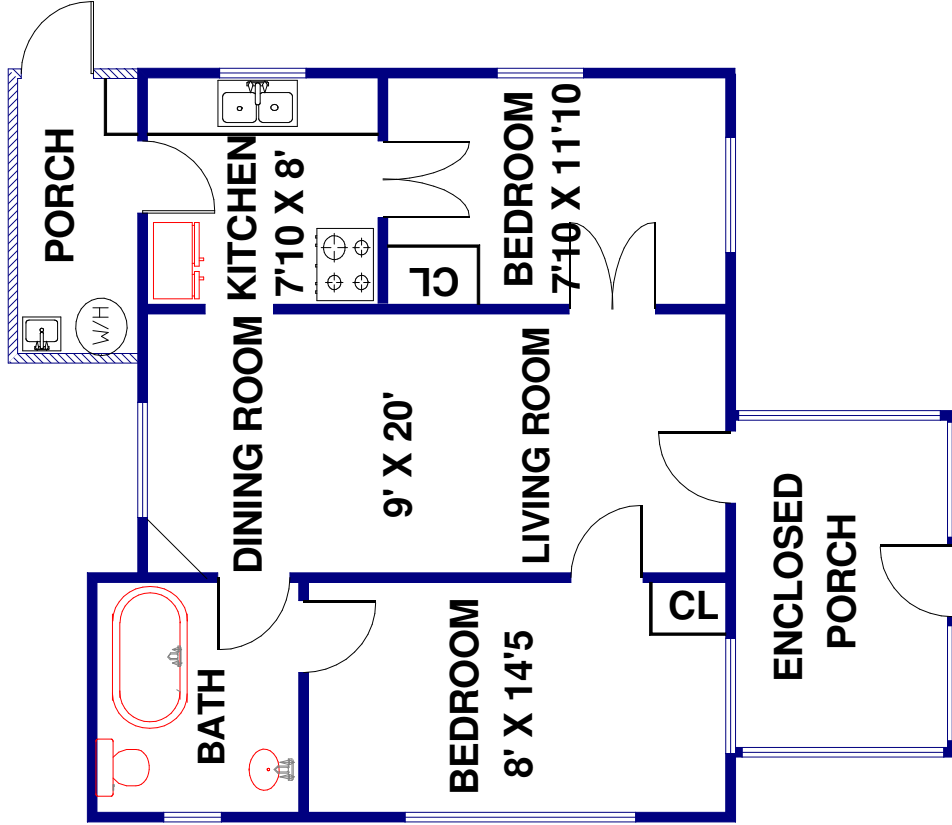

145 GROVE STREET, SIERRA MADRE

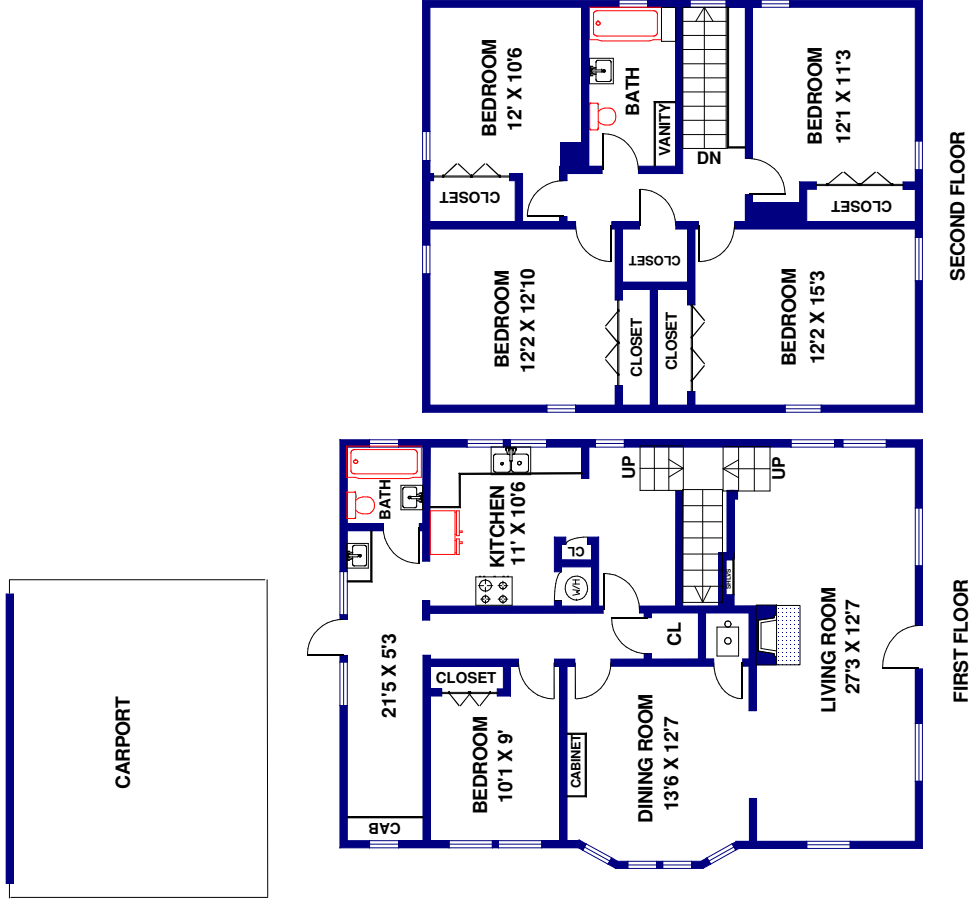

FLOOR PLAN CREATED BY REST. INFORMATION DEEMED RELIABLE, BUT NOT GUARANTEED. (626) 840-1717

FLOOR PLAN CREATED BY REST. INFORMATION DEEMED RELIABLE, BUT NOT GUARANTEED. (626) 840-1717